



Product Information Sheet

19" High Round Toilet with Rear Outlet and Powerful Flushing - T19HROR



Product Specifications

Product Type	Two-Piece toilet
Material	Ceramic
Bowl Shape	Round
Flush Type	Dual
Gallons Per Flush	1.28 gallons
Minimum Gallons Per Flush	0.8 gallons per minute
Flush Valve Included	Yes
Tank Lever Included	Yes
Trip Lever Placement	Top
Seat Included	Yes
Seat Lid Included	Yes
Trapway Design	Skirted
Skirted	Yes
Bolt Caps Included	Yes
Wax Ring Kit Included	Yes
Closet / Johni Bolts Included	Yes
Durability	Corrosion Resistant; Stain Resistant; Leak Resistant; Antimicrobial; Mold / Mildew Resistant
Craftsmanship Type	Hand Painted
Imported	Yes

Seat Material	Plastic
Finish	White
Antimicrobial	Yes
Flushometer Valve Type	Manual
Soft Closing	Soft Close Door Hinges
Cistern Included	Yes
Flush Actuator Included	Yes
Valve Type	Canister
Lid Closure	Soft Closure Lid
Power Type	Manual

Specifications

UPC Certified	Yes
---------------	-----

Assembly

Installation Required	Yes
Installation Type	Wall Mounted

Product Dimensions

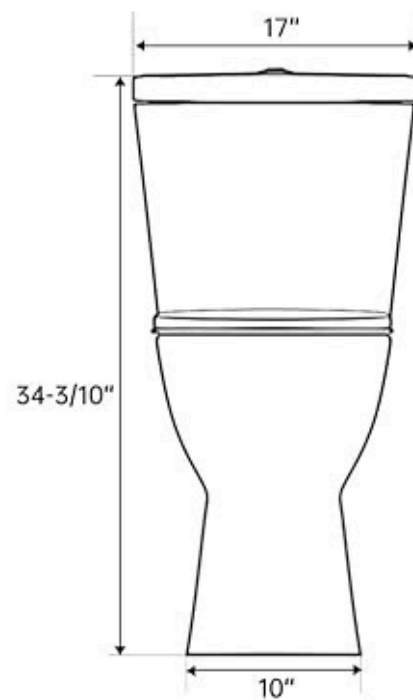
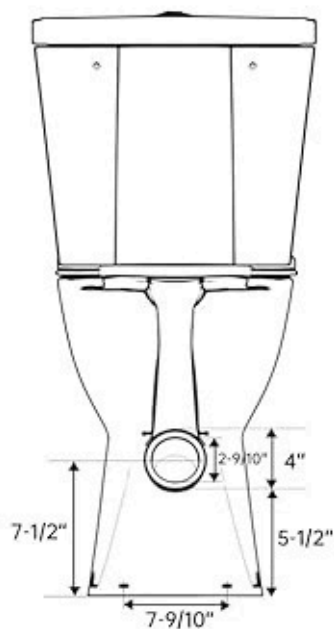
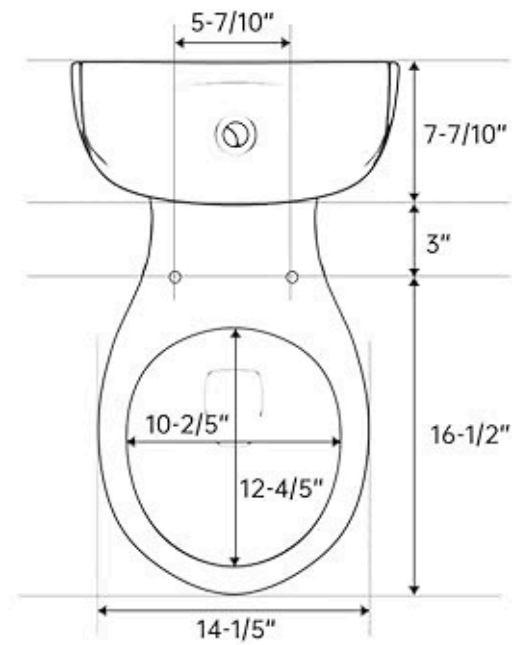
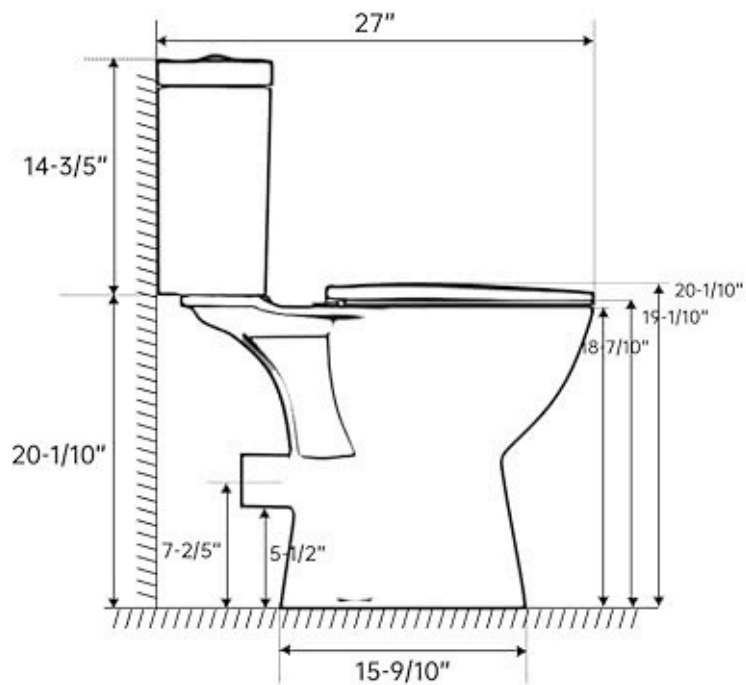

Installation Instructions

NOTE:

Read entire Rear Outlet Toilet Installation Instructions. Observe all local building and safety codes. These installation instructions are for a new toilet, it is assumed that all old fixtures have been removed and the toilet flange is in the new toilet.

Unpack and inspect the product for any shipping damage. Do not install if found damaged. Please contact customer service. If you are new to bathroom fixture installation, we recommend that you consult a professional. We are not responsible for any damage to floors, walls, pipes or personal injury during installation.

Tools Needed



Pencil



Hacksaw



Level



Drill



Adjustable Wrench

1. Install the tank

- If you are installing a two-piece toilet, slide the tank bolts through the mounting holes on the top of the base of the toilet and thread the washers and nuts onto the tank bolts. Verify that the tank is level and alternately tighten the washers and nuts until the tank is resting firmly on the bowl.
- If your toilet is one piece only, move on to the next step.



2. Position the toilet

- Place the toilet in the location where it will be installed.



3. Measure the toilet position

- Measure the distance from the back of the waste outlet on the toilet to the wall hub fitting to determine the length of the p-trap connector.
- The connector should extend approximately 1-1/2" into the hub fitting.



4. Mark the toilet position

- Mark the location of the pre-drilled mounting holes using the holes in the base of the toilet as a template.

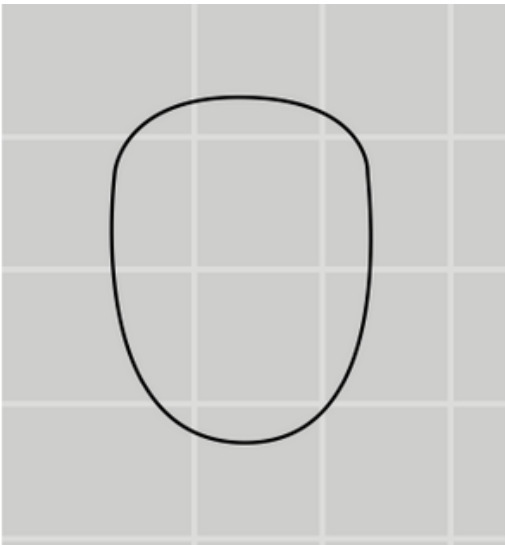

5. Drill the holes

- Remove the toilet from the work area and drill mounting holes in the locations designated in the previous step.

6. Install the toilet

- Slide the toilet into place and press the waste outlet into the p-trap connector.

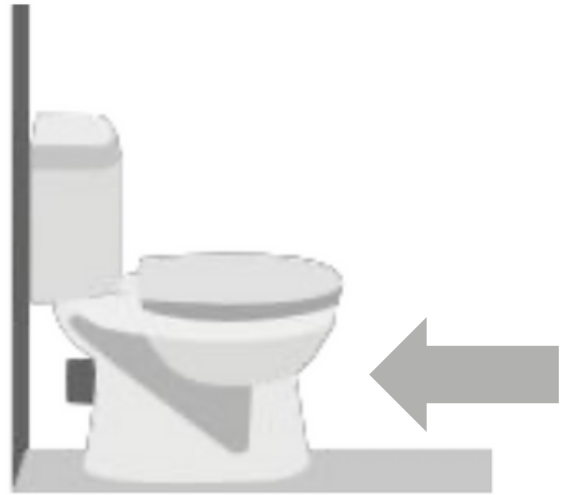

7. Secure the toilet

- Once the toilet is securely in place, insert anchor bolts and washers through the mounting holes in the base of the toilet and tighten into the pre-drilled holes created in step 5.



8. Place bolt caps

- Place caps over the anchor bolts on the base of the toilet.



9. Connect the water supply

- Connect the water supply tubes at the bottom of the tank.
- Turn on the water supply and flush the toilet several times to check for any leaks around the back or base.



10. Install the toilet seat

- Align the hinges of the new toilet seat with the bolt holes on the toilet bowl.
- Secure the seat by inserting the bolts through the holes in the hinges and into the toilet bowl.
- Tighten the nuts on the bolts ensuring the seat is secure but not too tight.



Product Installation—flush valve



Configuration Picture

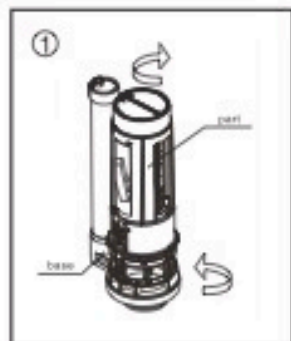

① rotate the body, separate it from the base

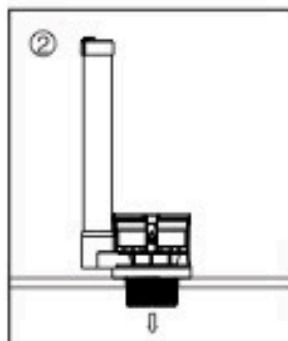

② Install the base into drainer hole, adjust it perfectly to the wall if water tank, rotate it with suitable angles.

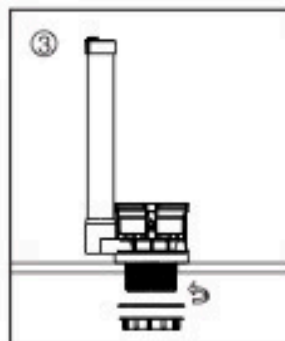

③ lock it with plastic screw, make the seal ring completely with tank draining hole, then install the valve.

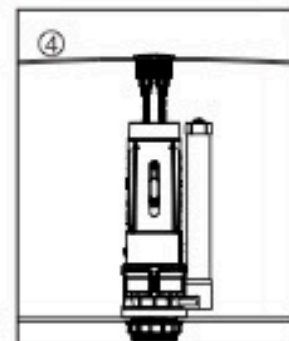

④ put button into the hole, rotate push rod and adjust its height to touch button.

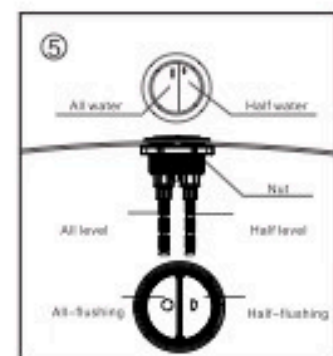

adjust the button to make the half level aim at Half water button, all level aim at all water button, rotate nut and lock it.

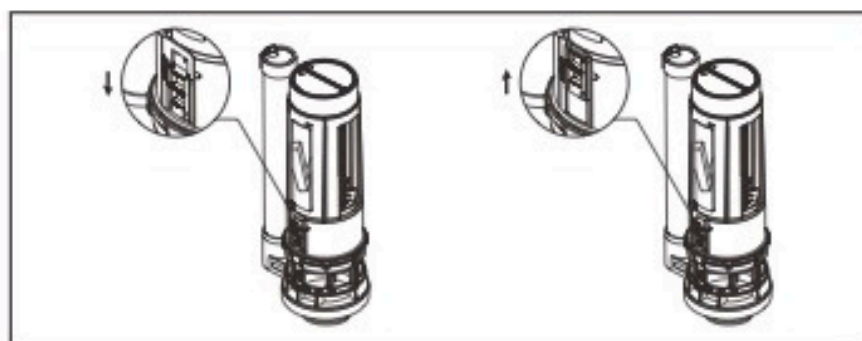

Adjust the all water controller to control its water volume, when turn it down, the button hole will close, its water volum, will be more, and vice versa.

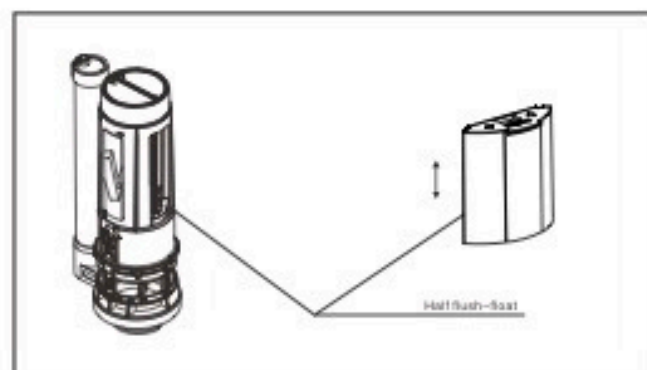

Adjust half key float to control its displacement, float is higher, its displacement will be less.



Screw-in, two-piece

Upon installation, back flow prevention complies with the requirements of AS/NZS 3500.1 shall be included.

Product Installation–fill valve

Configuration Picture

①



Take off the Hex nut, and put the Fill valve in to the hole, adjust the body position, lock the Hex nut.

②

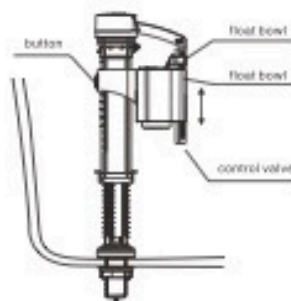

Water-level adjust:
NO.1: Press the float bowl, move out of the control valve and push the button to the "open" side. Adjust the bowl to the optional position, finally lock the control valve and the button.

③

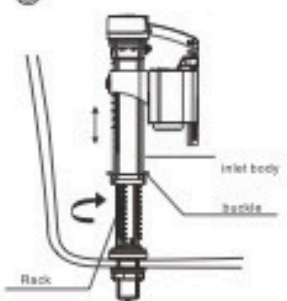

Water-level adjust:
NO.2: Push out of the buckle, Rotate the rack from the clock wise way, adjust the height, final rotate the rack to the original position.

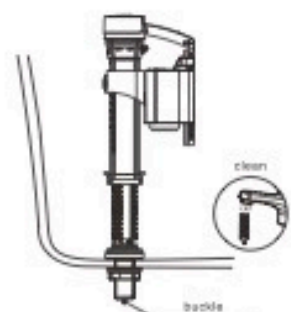

When the water can not be filled smoothly, please clean the buckle.

NOTICE:

1. Please read this manual carefully, and install the fill valve according to this to avoid product damage and human injury due to wrongful operation.
2. All the information is the latest until publishing, Wealwell has the right to change the product's feature, package and the ability to offer the product without any notice.
3. Do not use corrosion cleaner or solvent or any other related chemical ingredient, Cleaner or solvent with chlorine or Calcium hypochlorite etc will cause series damage to the water tank, cause water leakage. We do not take responsibility due to such reasons.
4. Do not use parts like glass glue not supplied by our company, to install the product, such damage caused by other supplier's parts we do not take responsibility.
5. Water temperature for this fill valve is 2°C-45°C, water pressure is 0.02MPa-0.8MPa.
6. Please refer to the actual products for confirmation.

Trouble shooting

malfunction	Solution
Leaking Water: Check the Hex nut is tight or not.	Lock the hex nut tightly
Flooding Water: The float bowl can not be fixed in the right way.	adjust the float bow or change the part
Water-filling not smooth: Check the buckle was jamming or not.	clean the buckle
Water level is too high or low: Check the level of the inlet valve.	adjust the inlet valve to the optional position
Other	please ask the technician for help